

VS51 SERIES

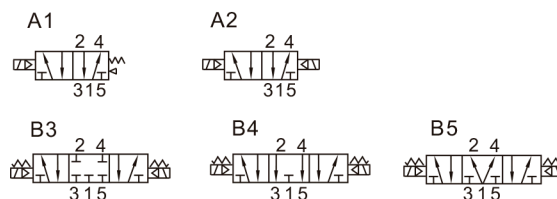

Symbol



Product feature

1. Pilot-oriented mode: Internal pilot or external pilot.
2. Structure in sliding column mode: good tightness and sensitive reaction.
3. Three position solenoid valves have three kinds of central function for your choice.
4. Double control solenoid valves have memory function.
5. Internal hole adopts special processing technology which has little attrition friction, low start pressure and long service life.
6. No need to add oil for lubrication.
7. It is available to form integrated valve group with the base to save installation space.
8. Affiliated manual devices are equipped to facilitate installation and debugging.
9. Several standard voltage grades are optional.

Flow chart

Model: VS51A101

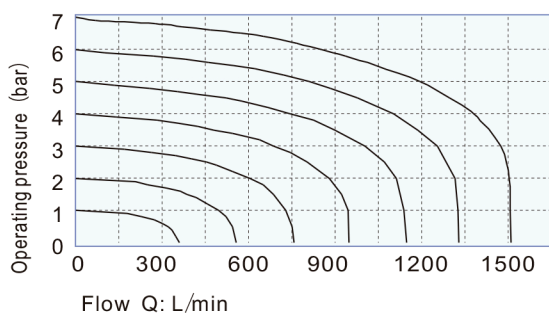

Model: VS51A102

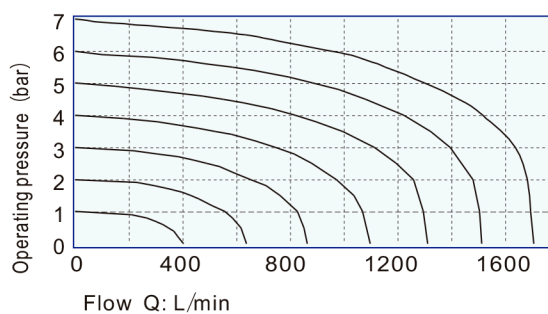

Ordering code

VS 5 1 A 1 01 - VC

① ② ③ ④ ⑤ ⑥ ⑦

①	Model VS: Solenoid valve	⑥	Port Size 01: 1/8" G 02: 1/4" G
②	Valve Type 5: 5/2 Way, 5/3 Way	⑦	Voltage DC: DC12V VC: DC24V CA: AC110V DA: AC220V VA: AC24V
③	Series Code 1: 1 Serie		
④	Directional control A: 2 Positions B: 3 Positions		
⑤	Acting 1: Single-acting 2: Double-acting 3: Double-acting closed center 4: Double-acting exhaust center 5: Double-acting pressure center		

Note: Please refer to page 140 for manifold specification and the order way.

Specification

Valve	VS51A101	VS51A201	VS51B301	VS51B401	VS51B501	VS51A102	VS51A202	VS51B302	VS51B402	VS51B502
Fluid	Air(to be filtered by 40 μm filter element)									
Acting	Internal pilot or external pilot									
Port size	In=Out=Exhaust=1/8"G					In=Out=1/4"G		Exhaust=1/8"G		
Valve type	5 port 2 position		5 port 3 position			5 port 2 position		5 port 3 position		
Lubrication	Not required									
Operating pressure	1.5~8bar(21~114psi)									
Proof pressure	15bar(215psi)									
Temperature °C	-20~70									
Orifice size	14.0mm ² (Cv=0.78)		12.0mm ² (Cv=0.67)			16.0mm ² (Cv=0.89)		12.0mm ² (Cv=0.67)		
Material of body	Aluminum alloy									

Coil specification

Item	Specification
Standard voltage	AC220V, AC110V, AC24V, DC24V, DC12V
Scope of voltage	AC:±15% DC:±10%
Power consumption	AC:3.5VA DC:3.0W
Protection	IP65(DIN40050)
Temperature classification	B Class
Electrical entry	Terminal
Activating time	0.05 sec and below
Max. frequency ①	5 cycle/sec

Note ①: The maximum actuation frequency is in the no-load state.

Inner structure

VS51A1

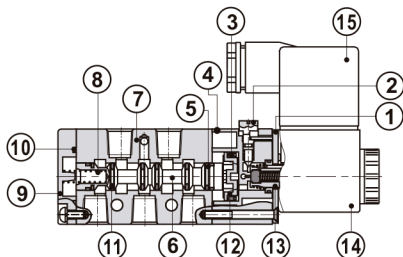

VS51A2

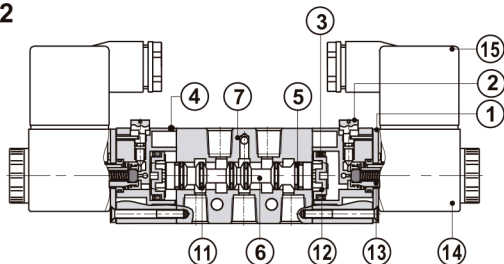

VS51B3

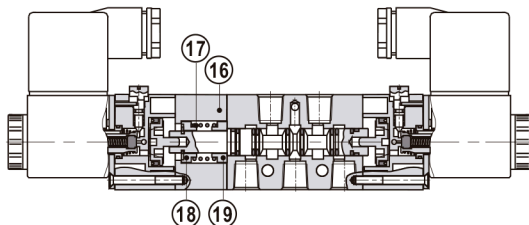

No.	Item
(1)	Fixed plate
(2)	Manual override
(3)	Piston O-ring
(4)	Pilot body
(5)	Spool packing
(6)	Spool
(7)	Body
(8)	Spool spring
(9)	Bottom cover
(10)	Bottom cover gasket
(11)	O-ring
(12)	Piston
(13)	Armature
(14)	Coil
(15)	Connector
(16)	Side cover
(17)	Return spring
(18)	Spring holder
(19)	Spring holder

VS51 SERIES

Dimensions

VS51A1

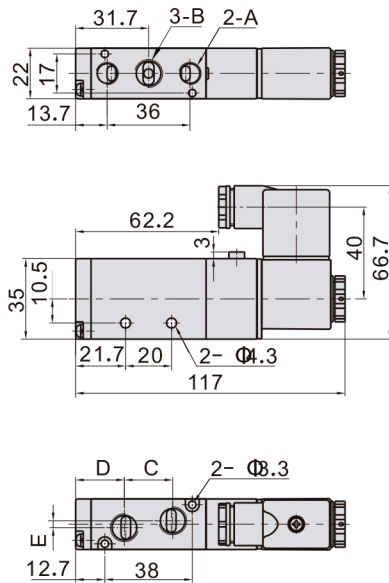

Model\Item	A	B	C	D	E
VS51A101	1/8"G	1/8"G	18	22.7	0
VS51A102	1/8"G	1/4"G	21	21.2	3

VS51A2

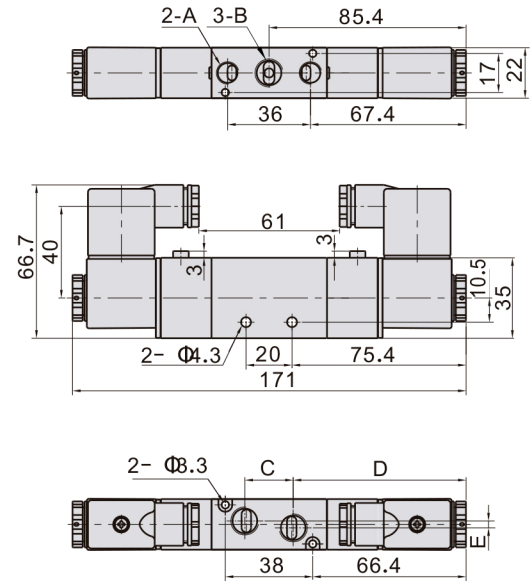

Model\Item	A	B	C	D	E
VS51A201	1/8"G	1/8"G	18	76.4	0
VS51A202	1/8"G	1/4"G	21	74.9	3

VS51B3\VS51B4\VS51B5

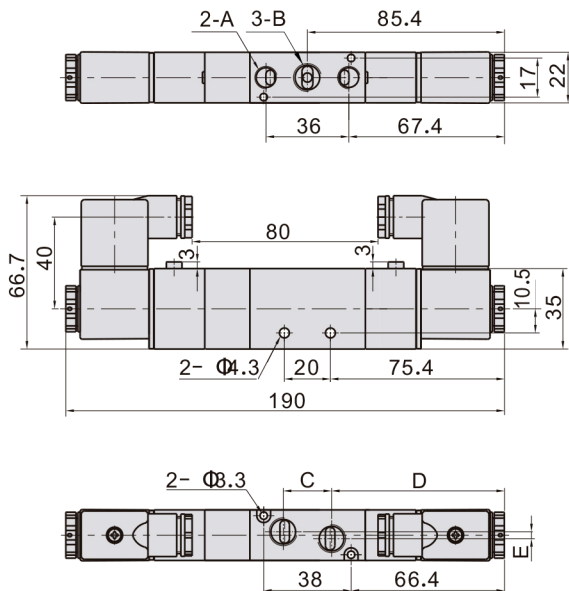

Model\Item	A	B	C	D	E
VS51B3(4\5)01	1/8"G	1/8"G	18	76.4	0
VS51B3(4\5)02	1/8"G	1/4"G	21	74.9	3